



1.74010.0001

Spectroquant®

Halogen lamp module Prove 100

Exchanging the lamp module

Warning

Before exchanging the lamp, switch the instrument off and disconnect the power plug from the power supply! If the lamp has snapped off or is broken, it must be exchanged by the Customer Service Department, as there is a risk of significant injury!

Caution

There is a risk of explosion if unsuitable lamps are used.
Only use the lamp that is intended for use with your instrument.

Procedure

1. Place the photometer bottom-side up on a soft surface.
2. Open the lamp compartment cover.

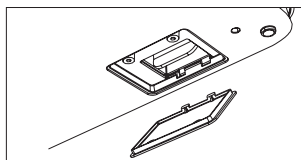
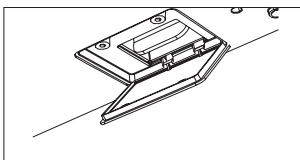
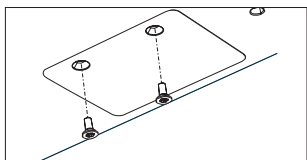

3. Carefully remove the lamp module from the lamp compartment.

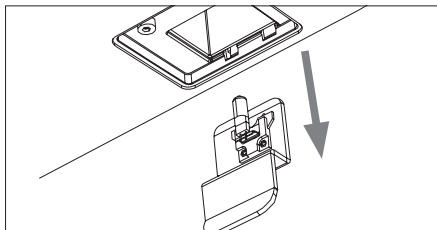

4. Install the new lamp module in the lamp compartment.

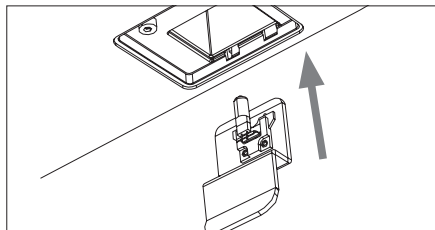

5. Close the lamp compartment cover.

Note

Upon renewed use of the photometer, reset the lamp counter to zero (see Operating Manual) and perform an instrument check for all measurements.

Disposal of the lamp

Dispose of the lamp at a suitable facility according to local legal requirements. Please do not dispose of the lamp along with household refuse.

Within the European Union, the lamp is removed at specialized treatment centers at the instrument's end of life. Instruments are taken to one of those specialized treatment centers via the recycling system set up for this purpose.

